



Appendix III Drawings :



APPENDIX III

Drawings

Drawing T-1050-C-0000-4GDD-0001:	Location Plan
Drawing T-1050-C-0000-4GDD-0002:	Stratigraphic Sections A-A and B-B
Drawing T-1050-C-0000-4GDD-0003:	Stratigraphic Sections C-C, D-D and E-E
Drawing T-1050-C-0000-4GDD-0004:	Stratigraphic Sections F-F, G-G and H-H
Drawing T-1050-C-0000-4GDD-0005:	Trial Excavation TE-A-05
Drawing T-1050-C-0000-4GDD-0006:	Trial Excavation TE-B-05
Drawing T-1050-C-0000-4GDD-0007:	Stratigraphic Section I-I (1 of 2)
Drawing T-1050-C-0000-4GDD-0008:	Stratigraphic Section I-I (2 of 2)

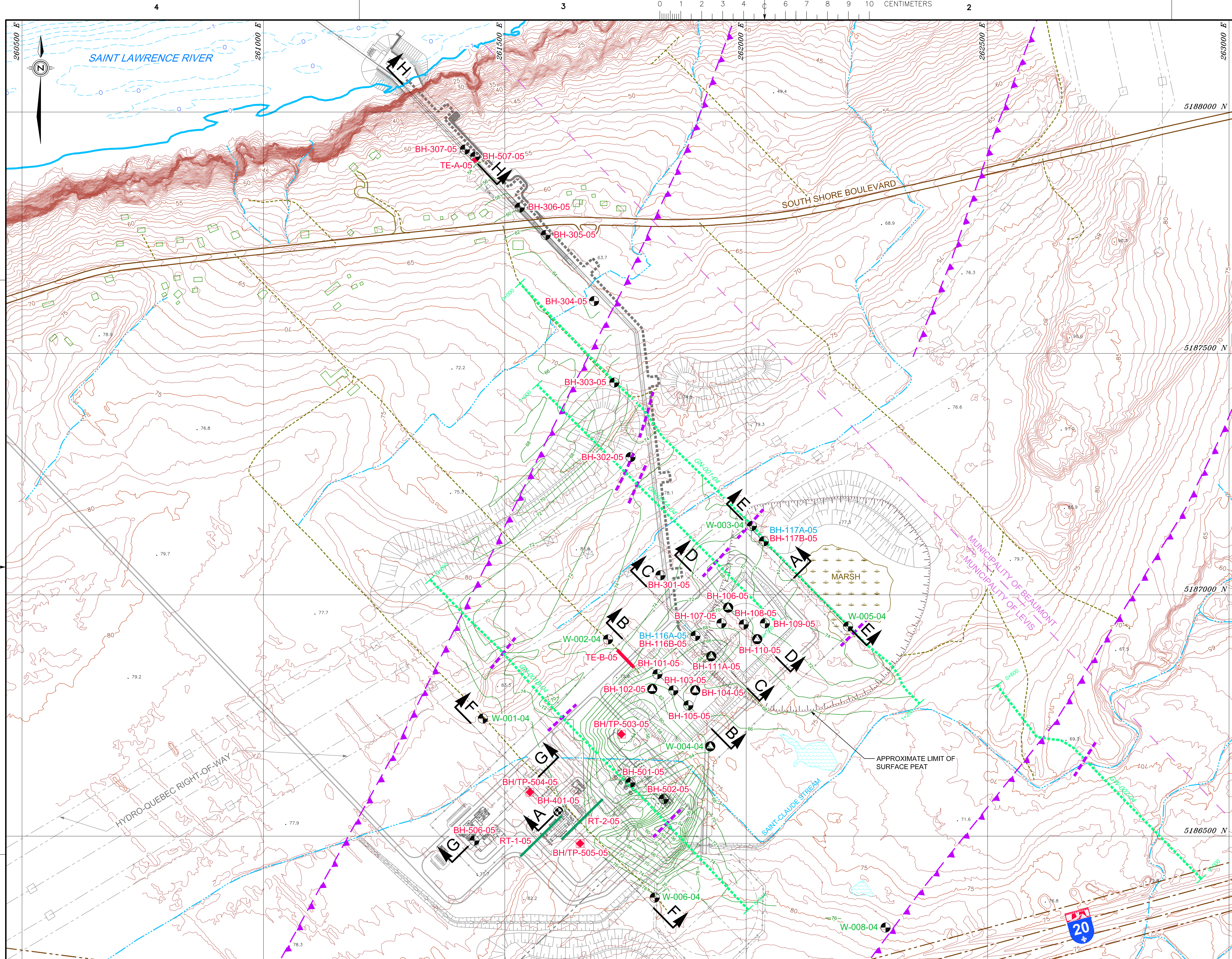

- ### LEGEND
- BH-101-05 VERTICAL BOREHOLE - RECENT INVESTIGATION (NOTE 5)
 - BH-401-05 BOREHOLE AND DYNAMIC PENETRATION TEST- RECENT INVESTIGATION (NOTE 5)
 - BH-117A INCLINED BOREHOLE - RECENT INVESTIGATION (NOTE 5)
 - BH-102-05 BOREHOLE WITH PIEZOMETER (OBSERVATION WELL) - RECENT INVESTIGATION (NOTE 5)
 - BH/TP-501-05 TEST PIT AND VERTICAL BOREHOLE - RECENT INVESTIGATION (NOTE 5)
 - W-001-04 VERTICAL BOREHOLE - PREVIOUS INVESTIGATION (TERRATECH REPORT T-1050-A DATED MARCH 2005)
 - W-004-04 BOREHOLE WITH PIEZOMETER (OBSERVATION WELL) - PREVIOUS INVESTIGATION (TERRATECH REPORT T-1050-A DATED MARCH 2005)
 - TE-B-05 TRIAL EXCAVATION (THIS REPORT)
 - RT-1-05 RESISTIVITY SOUNDING (THIS REPORT)
 - GW-002-04 SEISMIC REFRACTION SURVEY LINE (WITH CHAINAGE)
 - POSSIBLE FAULT (FROM MAP 4 OF GEOLOGICAL REPORT MB-94-40, SEE SAINT-JULIEN, P. 1995)
 - SEISMIC REFRACTION ANOMALY (FROM GEOPHYSICS GPR INTERNATIONAL INC. SURVEY / EXTENSION INTERPRETED BY TERRATECH)
 - PRIMARY GROUND SURFACE CONTOUR LINE - CONTOUR INTERVAL = 5m
 - SECONDARY GROUND SURFACE CONTOUR LINE - CONTOUR INTERVAL = 1m
 - BEDROCK SURFACE CONTOUR LINE - CONTOUR INTERVAL = 2m (NOTE 2)
 - RIVER BOTTOM CONTOUR LINE - CONTOUR INTERVAL = 1m (NOTE 3)
 - GROUND SURFACE SPOT ELEVATION IN METERS
 - STREAM
 - POND
 - MARSH / INUNDATED GROUND
 - PRIMARY ROAD / HIGHWAY
 - SECONDARY ROAD
 - EXISTING BUILDING
 - STRATIGRAPHIC SECTION (NOTE 4)

- ### NOTES
1. The coordinates shown on this drawing are in reference to SCOPQ - NAD83. All elevations are in meters and refer to geodetic datum.
 2. The bedrock surface contours were computer generated based on the bedrock surface elevation encountered at the sounding locations shown in plan. The actual bedrock surface between soundings may vary from that shown.
 3. Bathymetric survey carried out by Entreprises Normand Juneau inc. on the dates of October 5 - 7 and November 16 - 17, 2004.
 4. See drawings T-1050-C-0002 to 0008 for stratigraphic sections A-A to I-I.
 5. "Recent investigation" refers to exploration works carried out during the period of 8 February to 15 April, 2005 (report T-1050-B of May 2005) and during the period of 30 September to 4 November, 2005 (this report).
 6. This drawing is to be read in conjunction with the accompanying report.

ISSUE REGISTER		ISSUE REGISTER		REVISION REGISTER		REVISION REGISTER	
ISSUE No	REV. DATE (Y/M/D)	PURPOSE OF ISSUE	ISSUE No	REV. DATE (Y/M/D)	PURPOSE OF ISSUE	No	REVISION DESCRIPTION
1	0	2006-05-01	ISSUED WITH FINAL REPORT T-1050-C				

PROFESSIONAL SEAL

Division of SNC-Lavalin Environment Inc.

CLIENT

Rabaska RABASKA LNG IMPORT TERMINAL
QUEBEC, CANADA

PROJECT
**RABASKA - LNG RECEIVING TERMINAL
LEVIS/BEAUMONT**
QUEBEC

TITLE
LOCATION PLAN

PREPARATION

DESIGNED: R. Bousquet, M.A.Sc., Eng.

DRAWN: R. Anderson

CHECKED: R. Bousquet, M.A.Sc., Eng.

DATE: 2005-08-16

APPROVAL

PROJECT DISCIPLINE ENGINEER: H. Madjar, M.A.Sc., Eng.

PROJECT ENGINEERING MANAGER

CLIENT

SCALE: 1:4 000

LAST SAVE: 2006/05/23 - 12:42pm
 PATH: Z:\604238_40\T-1050-C-1.dwg